

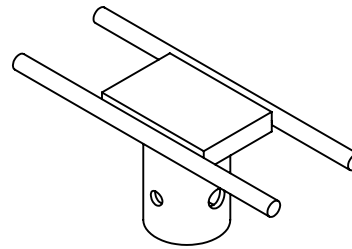

GRADE BEAM PIER CAP

P/N: MHC1000

Application View

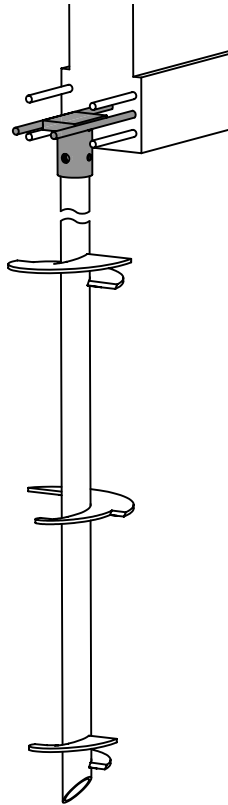

Note: All dimensions are in inches and shown for reference only. For product specific Engineering Drawings, please contact Magnum Piering Engineering Department.

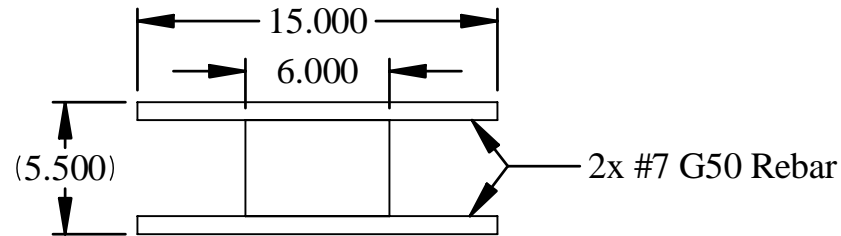

Product Specifications

Material:

Plate to be ASTM A-36 or better.
 Tube to be ASTM A500 Grade C or better.
 Rebar to be Grade 50, #7

Product Weight: 14 lbs

Capacity:

See Magnum Steel Push Piering Technical Reference Manual for specific capacity information.

