

MAGNUM[®] MHC1080-3 Tie-Back Cap

Allowable Capacity - 16 Tons Compression / 16 Tons Tension

3-Inch I.D. Collar for use with (1) No. 10, Gr. 75 Thread Bar

Fits MH313, MH313R, MH325, MH325R Magnum[®] Helical Piles



Description

Magnum MHC1080-3 tie-back cap has 32 tons ultimate capacity, 16 tons working capacity in compression and tension. The tie-back cap consists of a collar tube with bolt hole for connection to Magnum helical piles and thread bar for attachment to various earth retention structures. The tie-back cap is designed in accordance with ICC-ES document AC358 as well as IBC, ACI, and AISC codes. Design and detailing of the structure to which the helical pile cap is attached varies by project and is the responsibility of registered design professional including waler size (if any), bearing plate, wall facing (if any), and concrete cover as applicable.

SPECIFICATIONS	
Collar Tube	0.3 in. x 3 in. I.D. ASTM A513 GR65+
End Effector	(1) #10 GR75 Thread Bar (sold separately)
Pile Connection	(1) 7/8" SAE GR5 / ASTM A325
Surface Coating	Galvanized per ASTM A153/A123 (G), Bare Steel (NG), or Epoxy Coated per ICC-ES AC228 (EP)
Compatibility	MH313, MH313R, MH325, MH325R

* Connection bolt size differs from pre-drilled hole in MH325R making field drilling of pile shaft required.

CAP CAPACITY	
Ultimate Compression / Tension	32 Tons / 32 Tons
Allowable Compression / Tension	16 Tons / 16 Tons

Note: Cap capacity takes into account strength of collar, end effector, and pile connection. Capacity may be limited by the helical pile itself, bearing/pullout capacity of soil, or strength of the structure to which the cap is attached, whichever is less.

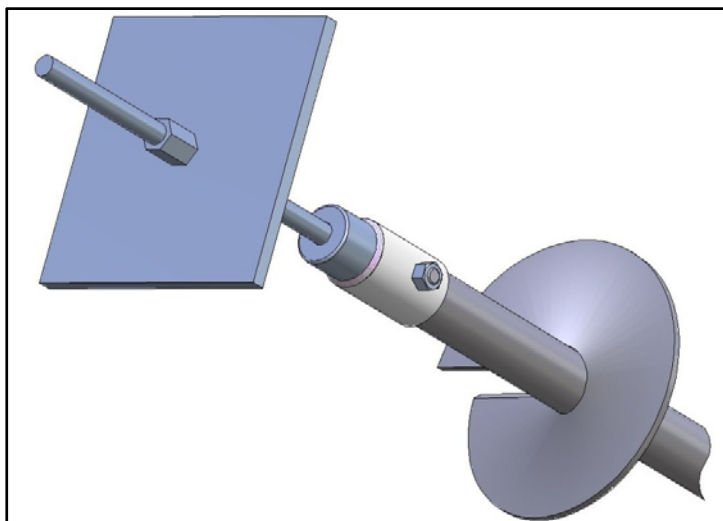
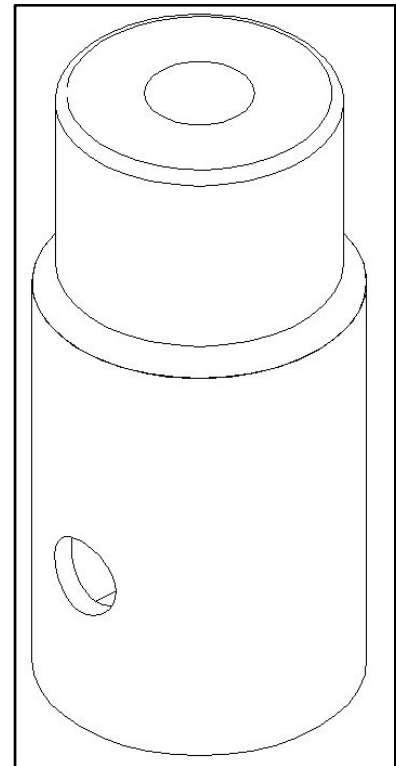

Installation Notes:

After installation of a Magnum Helical Anchor or Pile to the correct depth, torque, and capacity, begin by cutting-off the pile shaft at the proper elevation. For Bolted "B" applications, drill connection holes thru the pile shaft using a Magnum drill template. Install the pile cap, pile connection bolts, and snug-tighten nuts. For Welded "W" applications, plug weld cap in-place using the manufactured holes in the cap collar tube. Remove coatings from surfaces prior to welding. Snug tighten or post-tension thread bar nut against bearing plate as required for the project.

All Magnum Steel & Products Made in U.S.A.

Magnum Piering, Inc.

6082 Schumacher Park Dr.

West Chester, OH 45069

800-822-7437

www.magnumpiering.com

© Copyright 2010 Magnum Piering, Inc. All Rights Reserved.
U.S. Patents 6,058,662 and 5,234,287; Other Patents Pending.